

## Energy Storage Series

### 300A, 350A Energy Storage Waterproof Connctors



## Product Overview:

This product's technical performance complies with international standards such as UL, TUV, and RoHS; the male and female ends are secured with a press-fit latch design, offering the advantages of secure locking, smooth mating and demating, and can be mated and demated more than 100 times; the housing is made of PA66+GF material, ensuring the product has stable electrical performance, as well as excellent physical and chemical properties such as high-temperature resistance and corrosion resistance; at the same time, the conductive parts are processed with a silver-plated surface treatment, providing excellent conductivity and meeting the product's temperature rise requirements even in high-temperature environments.

This series of products offers a variety of models, providing options of 350A/300A for users to choose from. The negative pole of this product has a black appearance and the positive pole has an orange appearance, with red also available for selection.

Compliance standards: Meets UL, TUV, RoHS, CE, and other standards.

## Reference Standard:

UL4128 GBT11918.1-2014 GBT4208-2017 GBT35935.1 QC/T 417.1-2001

## Materials and Finishes:

Electroconductive parts: Phosphor Bronze T2 , Beryllium Copper/Silver Plating

Housing: PA66+GF

Insulator: PA66+GF

Seal: Silicone

Spring: Stainless Steel SUS304

## Electrical Characteristics :

Rated Voltage: 1500V DC

Rated Current : 350A/300A

Insulation Resistance : 5500VDC/500M

Withstand Voltage (AC) : 7000VDC

Contact Resistance :  $\leq 1\text{m}$

## Mechanical Characteristics:

Mating Cycle Life :  $\geq 100$ 次

Pin Retention Force :  $\geq 300\text{N}$

Plug-Socket Retention Force :  $\geq 150\text{N}$

## Environmental Characteristics:

Operating Temperature : -40 ~+125

Protection Rating : IP67

Salt Spray Requirement : 72H

Altitude : 2000m Max

## Connector Model and Cable Selection Table :

Product Series	Wire Cross-Sectional Area(mm <sup>2</sup> )	Rated Current (A)
E350	120	350
E300	95	300

## Nomenclature Rules:

E XXX - X X X X X X

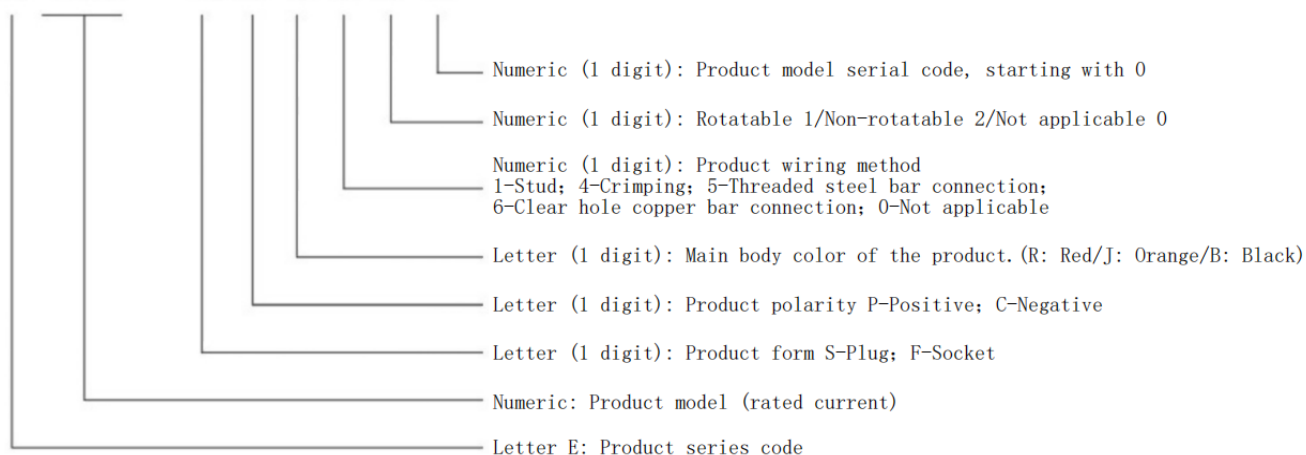

## Installation Requirements :

The wire and plug end are connected using a riveting method, while the wire and socket end can adopt one of four methods: stud bolt, light hole copper busbar, crimping, or stud.

The riveting should be secure and free from looseness.

The product's external dimensions and mounting dimensions are as shown in the following figure.

### E350/E300 Series Plug:

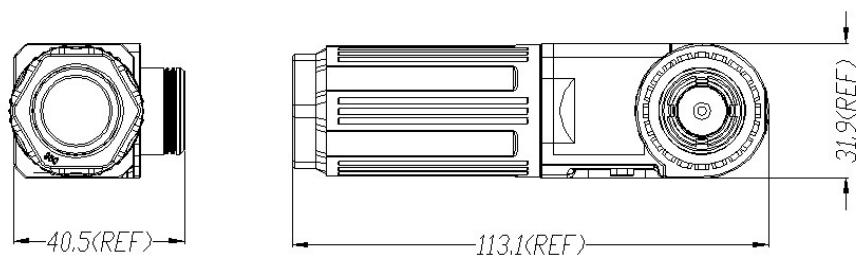

### E350/E300 Series Socket:

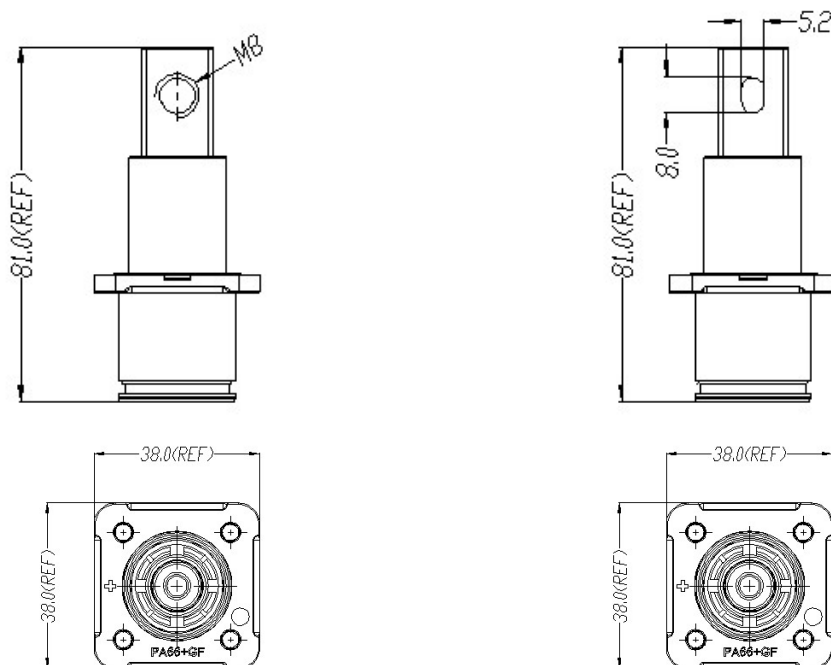

Threaded  
Copper Bar Terminal

Through Hole  
Copper Bar Terminal

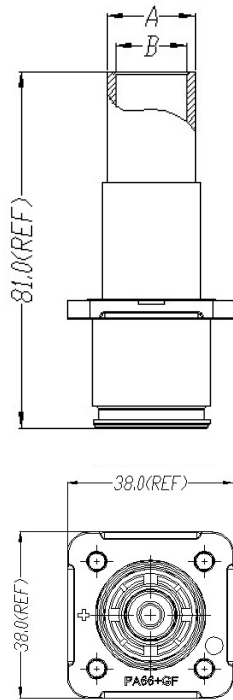

Cri mping

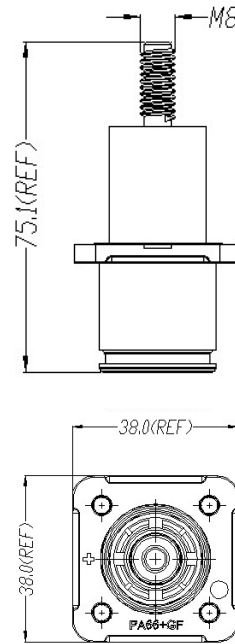

Stud

Series	Wire Gauge (mm <sup>2</sup> )	Size (B)
E350	120	ø 17
E300	95	ø 13

## Mounting Hole Dimensions :

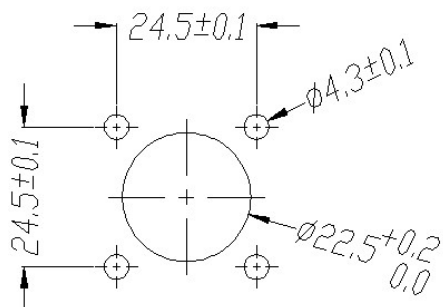

安装孔尺寸